



# TUBOTECNICA

## CONEXÕES RANHURADAS



*Definitivamente a solução mais competitiva!*

# Conexões ranhuradas

---

## CONEXÕES RANHURADAS

---

Os acoplamentos ranhurados são constituídos por dois segmentos de acoplamentos em ferro fundido dúctil, um vedante em EPDM, e dois conjuntos de parafusos e porcas.

A ranhura na tubulação de aço é feita por deformação a frio. Pode ser instalada com tubulação de aço com costura e sem costura, galvanizada ou em preto.

O sistema de conexões ranhuradas pode ser instalado em diversas especialidades:

- Incêndio, bicos de sprinkler e hidrantes;
- Ar comprimido;
- Água gelada;
- Mineração;
- Processos industriais;
- Abastecimento de água.

## BENEFÍCIOS DAS CONEXÕES RANHURADAS

---

Nosso produto tem impacto na redução do custo da obra, o que pode ser comprovado pelos seguintes indicadores:

- Vida útil de 50 anos;
- Maior facilidade e rapidez na instalação em comparação a produtos que exigem solda;
- Preço menor que produtos exigem solda;
- Elimina necessidade de contratação de profissionais especializados em solda;
- Diferentemente de ligas com solda, cuja instalação ou manutenção exigem isolamento de área e interrupção de serviços, nossas conexões provocam o menor impacto possível no andamento da obra ou no ambiente do estabelecimento.

## CERTIFICADOS DE QUALIDADE

---

As conexões que a Tubotecnica distribui possuem certificados de qualidade que garantem integridade, confiabilidade e segurança.

Dentre os certificados exigidos destacam-se os FM e UL.



# Conexões ranhuradas

## ACOPLAMENTO RIGIDO UL/ FM

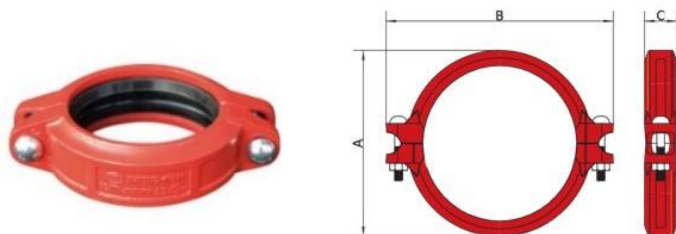

CÓDIGO	BITOLA	A	B	C	Peso	Pressão	Preço
AR121	1"(33,7mm)	55	97	45	0,420	300	*****
AR12114	1 ¼"(42,2mm)	63	107	45	0,530	300	*****
AR12112	1½"(48,3mm)	69	114	45	0,550	300	*****
AR122	2"(60,3mm)	83	124	46	0,680	300	*****
AR1273	2½"(73mm)	98	137	46	0,800	300	*****
AR12212	2½"(76mm)	98	139	46	0,800	300	*****
AR123	3"(88,9mm)	114	156	46	0,950	300	*****
AR124	4"(114,3mm)	142	189	50	1,400	300	*****
AR125	5"(139,7mm)	170	222	50	1,800	300	*****
AR12141	5"(141mm)	170	218	50	1,800	300	*****
AR12165	6"(165,1mm)	196	244	50	2,150	300	*****
AR12168	6"(168,3mm)	198	251	50	2,150	300	*****
AR128	8"(219,1mm)	256	316	60	3,850	300	*****
AR1210	10"(273mm)	319	393	64	6,300	300	*****
AR1212	12"(323,9mm)	374	453	65	8,850	300	*****

## ACOPLAMENTO FLEXÍVEL UL/FM

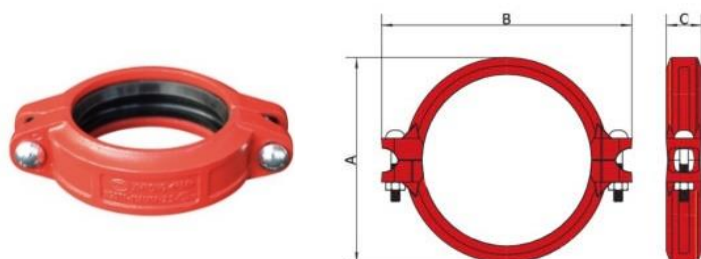

CÓDIGO	BITOLA	A	B	C	Peso	Pressão	Preço
AR121	1"(33,7mm)	55	97	45	0,420	300	*****
AR12114	1 ¼"(42,2mm)	63.5	107.5	45	0,530	300	*****
AR12112	1½"(48,3mm)	69	114	45	0,550	300	*****
AR122	2"(60,3mm)	83.6	124	46	0,680	300	*****



## Conexões ranhuradas

AR1273	2½"(73mm)	98	137	46	0,800	300	*****
AR12212	2½"(76mm)	98	139	46	0,800	300	*****
AR123	3"(88,9mm)	114	156	46	0,950	300	*****
AR124	4"(114,3mm)	142	189	50	1,400	300	*****
AR125	5"(139,7mm)	170	222	50	1,800	300	*****
AR12141	5"(141mm)	170	218	50	1,800	300	*****
AR12165	6"(165,1mm)	196	244	50	2,150	300	*****
AR12168	6"(168,3mm)	198	251	50	2,150	300	*****
AR128	8"(219,1mm)	256	316	60	3,850	300	*****
AR1210	10"(273mm)	319	393	64	6,300	300	*****
AR1212	12"(323,9mm)	374	453	65	8,850	300	*****

## ACOPLAMENTO DE REDUÇÃO FLEXÍVEL UL/FM

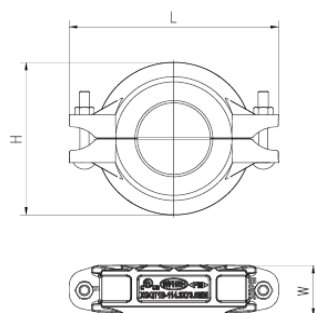

CÓDIGO	BITOLA	L	H	W	Peso	Pressão	Preço
AR25732	2½" x 2" (73 x 60,3mm)	143	102	45	1,120	300	*****
AR252122	2½" x 2" (76,1 x 60,3mm)	143	102	45	1,120	300	*****
AR2532	3" x 2" (88,9 x 60,3mm)	163	118	47	1,700	300	*****
AR25373	3" x 2½" (88,9 x 73mm)	163	118	47	2,150	300	*****
AR2542	4" x 2½" (114,3 x 73mm)	200	150	50	2,700	300	*****
AR25473	4" x 2½" (114,3 x 76,1mm)	200	150	50	2,700	300	*****
AR2543	4" x 3" (114,3 x 88,9mm)	200	150	50	2,380	300	*****
AR251654	6" x 4" (165,1 x 114,3mm)	270	200	51	4,200	300	*****
AR251684	6" x 4" (168,3 x 114,3mm)	270	200	51	4,200	300	*****
AR25168	8" x 6" (219,1 x 168,3mm)	335	260	63	7,480	300	*****



# Conexões ranhuradas

## ADAPTADOR FLANGE ANSI UL/FM 150lbs

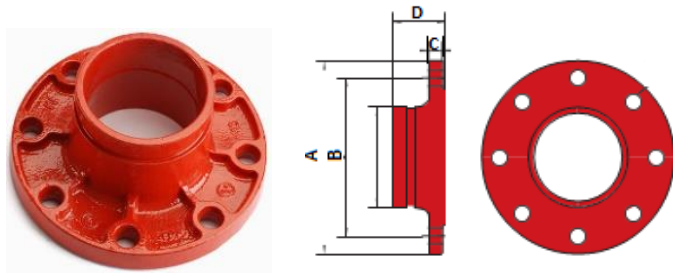

CÓDIGO	BITOLA	A	B	C	D	Peso	Pressão	Preço
AR19573	2½" (73,1mm)	143	125	45	60	2,850	300	*****
AR1953	3" (88,9mm)	143	145	45	60	3,080	300	*****
AR1954	4" (114,3mm)	163	160	47	60	5,150	300	*****
AR195141	5" (141mm)	163	180	47	65	8,900	300	*****
AR195168	6" (168,3mm)	200	210	50	65	8,900	300	*****
AR1958	8" (219,1mm)	200	240	50	70	8,900	300	*****
AR19510	10" (273mm)	200	295	50	85	9,900	300	*****
AR19512	12" (323,9mm)	270	335	51	85	10,900	300	*****

## FLANGE RANHURADO ANSI UL/FM 150lbs

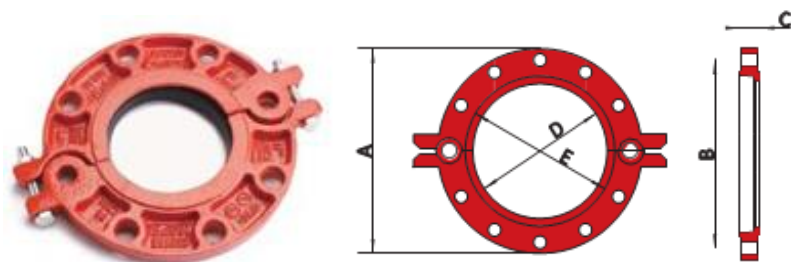

CÓDIGO	BITOLA	A	B	C	D	E	Peso	Pressão	Preço
AR182	2" (60,3mm)	164	125	25	60	78	1,920	300	*****
AR1873	2½" (73mm)	182	145	25	73	93	2,460	300	*****
AR183	3" (88,9mm)	194	160	25	89	107	2,870	300	*****
AR184	4" (114,3mm)	216	180	25	114	131	3,380	300	*****
AR18141	5" (141mm)	247	210	25	141	157	4,110	300	*****
AR18168	6" (168,3mm)	282	240	25	168	185	4,580	300	*****
AR188	8" (219,1mm)	335	295	27	219	234	6,850	300	*****
AR1810	10" (273mm)	373	335	27	362	362	8.480	300	*****
AR1812	12" (323,9mm)	323	335	27	432	432	10.28	300	*****



## Conexões ranhuradas

### ADAPTADOR DE RANHURA ROSCA UL/FM



CÓDIGO	BITOLA	A	Pressão	Peso
AAR19111	1" (33,7mm)		300	2,850
AR191112112	1 ½" (60,3mm)		300	3,080
AR19122	2" (60,3mm)		300	5,150
AR191212212	2 ½" (76,1mm)	85	300	8,900
AR19121273	2 ½" (73,0mm)	85	300	8,900

### ADAPTADOR DE RANHURA ROSCA Fabricado



CÓDIGO	BITOLA	A	Pressão	Peso
MAN19111	1" (33,7mm)	70	300	2,850
MAN19114114	1 ¼" (42,2mm)	70	300	3,080
MAN191112112	1 ½" (48,3mm)	70	300	5,150
MAN19122	2" (60,3mm)	70	300	8,900
MAN191212212	2 ½" (73mm)	70	300	8,900
MAN191212212	2 ½" (76mm)	70	300	8,900
MAN1913	3" (88,9mm)	70	300	
MAN1914	4" (114,3mm)	70	300	



# Conexões ranhuradas

## CRUZETA RANHURADA UL/FM

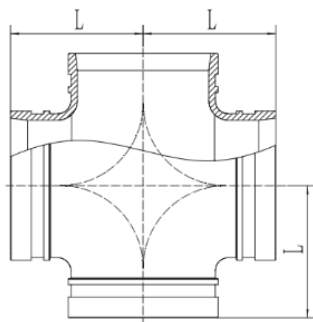

CÓDIGO	BITOLA	L	Pressão	Preço	Preço
AR1351	1" (33,7mm)	57	0,78	300	*****
AR135114	1 ¼" (42,2mm)	60	1	300	*****
AR135112	1 ½" (48,3mm)	60	1,15	300	*****
AR1352	2" (60,3mm)	70	1,41	300	*****
AR13573	2 ½" (73mm)	76	1,77	300	*****
AR135212	2 ½" (76mm)	76	1,77	300	*****
AR1353	3" (88,9mm)	86	2,44	300	*****
AR1354	4" (114,3mm)	102	3,44	300	*****
AR1355	5" (139,7mm)	124	2,97	300	*****
AR135141	5" (141mm)	124	8,68	300	*****
AR135165	6" (165,1mm)	140	8,68	300	*****
AR135168	6" (168,3mm)	140	8,68	300	*****
AR1358	8" (219,1mm)	173	17	300	*****
AR13510	10" (273mm)	215	20,5	300	*****
AR13512	12" (323,9mm)	245	33	300	*****

## JOELHO RANHURADO 90° UL/FM



CÓDIGO	BITOLA	A	Peso	Pressão	Preço
AR1051	1" (33,7mm)	57	0,310	300	*****
AR105114	1 ¼" (42,4mm)	60	0,430	300	*****
AR105112	1 ½" (48,3mm)	60	0,460	300	*****
AR1052	2" (60,3mm)	70	0,620	300	*****
AR10573	2 ½" (73mm)	76	0,880	300	*****



## Conexões ranhuradas

AR105212	2½" (76,1mm)	76	0,880	300	*****
AR1053	3" (88,9mm)	86	1,200	300	*****
AR1054	4" (114,3mm)	102	2,000	300	*****
AR1055	5" (139,7mm)	124	3,400	300	*****
AR105141	5" (141mm)	124	3,400	300	*****
AR105165	6" (165,1mm)	140	4,050	300	*****
AR105168	6" (168mm)	140	5,100	300	*****
AR1058	8" (219,1mm)	173	8,500	300	*****
AR10510	10" (273mm)	215	15,130	300	*****
AR10512	12" (323,9mm)	245	21,000	300	*****

## JOELHO RANHURADO 45° UL/FM

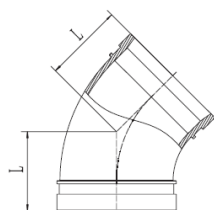

CÓDIGO	BITOLA	A	Peso	Pressão	Preço
AR1061	1" (33,7mm)	44	0,26	300	*****
AR106114	1¼" (42,4mm)	44	0,300	300	*****
AR106112	1½" (48,3mm)	44	0,360	300	*****
AR1062	2" (60,3mm)	51	0,600	300	*****
AR10673	2½" (73mm)	57	0,830	300	*****
AR106212	2½" (76,1mm)	57	0,830	300	*****
AR1063	3" (88,9mm)	64	1,130	300	*****
AR1064	4" (114,3mm)	76	1,380	300	*****
AR1065	5" (139,7mm)	83	2,600	300	*****
AR106141	5" (141mm)	83	2,600	300	*****
AR106165	6" (165,1mm)	89	3,050	300	*****
AR106168	6" (168mm)	89	3,050	300	*****
AR1068	8" (219,1mm)	108	5,900	300	*****
AR10610	10" (273mm)	121	11,100	300	*****
AR10612	12" (323,9mm)	133	12,000	300	*****





# Conexões ranhuradas

## JOELHO RANHURADO 22,5° UL/FM



CÓDIGO	BITOLA	A	Peso	Pressão	Preço
AR106114	1¼" (42,4mm)	45	0,300	300	*****
AR106112	1½" (48,3mm)	45	0,360	300	*****
AR1062	2" (60,3mm)	48	0,600	300	*****
AR10673	2½" (73mm)	51	0,830	300	*****
AR106212	2½" (76,1mm)	51	0,830	300	*****
AR1063	3" (88,9mm)	57	1,130	300	*****
AR1064	4" (114,3mm)	73	1,380	300	*****
AR1065	5" (139,7mm)	73	2,600	300	*****
AR106141	5" (141mm)	73	2,600	300	*****
AR106165	6" (165,1mm)	89	3,050	300	*****
AR106168	6" (168mm)	89	3,050	300	*****
AR1068	8" (219,1mm)	98	5,900	300	*****

## JOELHO RANHURADO 11,25°



CÓDIGO	BITOLA	A	Peso	Pressão	Preço
AR1032	2" (60,3mm)	35	0,400	300	*****
AR10373	2½" (73mm)	38	0,720	300	*****
AR103212	2½" (76,1mm)	38	0,720	300	*****
AR1033	3" (88,9mm)	38	0,850	300	*****
AR1034	4" (114,3mm)	44	1,250	300	*****
AR1035	5" (139,7mm)	51	1,820	300	*****
AR103165	6" (165,1mm)	51	2,680	300	*****
AR103168	6" (168mm)	51	2,680	300	*****
AR1038	8" (219,1mm)	51	3,800	300	*****



## Conexões ranhuradas

### JOELHO REDUÇÃO RANHURA X ROSCA 90° UL/FM

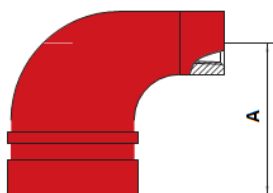

CÓDIGO	BITOLA	A	Peso	Pressão	Preço
AR105END11412	1¼" x ½" (42,4 x RC ½")	61	0,300	300	*****
AR105END11434	1¼" x ¾" (42,4 x RC ¾")	61	0,300	300	*****
AR105END1141	1½" x 1" (42,4 x RC 1")	61	0,300	300	*****
AR105END11212	1½" x ½" (48,3 x RC ½")	64	0,350	300	*****
AR105END11234	1½" x ¾" (48,3 x RC ¾")	64	0,420	300	*****
AR105END1121	1½" x 1" (48,3 x RC 1")	64	0,450	300	*****
AR105END212	2" X ½" (60,3 x RC ½")	70	0,380	300	*****
AR105END234	2" X ¾" (60,3 x RC ¾")	70	0,410	300	*****
AR105END21	2" X 1" (60,3 x RC 1")	70	0,530	300	*****

### TE SIMPLES RANHURADO

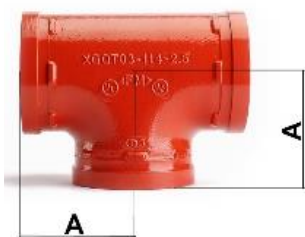

CÓDIGO	BITOLA	A	Peso	Pressão	Preço
AR1071	1" (33,7mm)	57	0,500	300	*****
AR107114	1¼" (42,4mm)	60	0,530	300	*****
AR107112	1½" (48,3 mm)	60	0,600	300	*****
AR1072	2" (60,3mm)	70	0,870	300	*****
AR10773	2½" (73 mm)	76	1,190	300	*****
AR107212	2½" (76 mm)	76	1,270	300	*****
AR1073	3" (88,9 mm)	85	1,660	300	*****
AR1074	4" (114,3 mm)	102	2,650	300	*****
AR1075	5" (139,7 mm)	121	4,280	300	*****
AR107141	5" (141 mm)	121	5,000	300	*****
AR107165	6" (165,1 mm)	130	5,130	300	*****
AR107168	6" (168,3mm)	140	5,540	300	*****
AR1078	8" (219,1 mm)	17	11,540	300	*****
AR10710	10" (273 mm)	215	14,500	300	*****
AR10712	12" (323,9 mm)	245	25,000	300	*****



# Conexões ranhuradas

## TE DE REDUÇÃO RANHURADO UL/FM



CÓDIGO	BITOLA	A	Peso	Pressão	Preço
AR1152114	2" x 11/4" (60,3 x 42mm)	70	1,000	300	*****
AR1152112	2" x 1½" (60,3 x 48,3mm)	70	1,000	300	*****
AR11573112	2½" x 1½" (73 x 48,3mm)	76	1,350	300	*****
AR115732	2½" x 2" (73 x 60,3mm)	76	1,400	300	*****
AR115212114	2½" x 1¼" (76,1 x 42,4mm)	76	1,250	300	*****
AR115212112	2½" x 2½" (76,1 x 48,3mm)	76	1,350	300	*****
AR1152122	2½" x 2" (76,1 x 60,3mm)	76	1,400	300	*****
AR11532	3" x 2" (88,9 x 60,3mm)	85	1,750	300	*****
AR115373	3" x 2½" (88,9 x 73,0mm)	85	1,750	300	*****
AR1153212	3" x 2½" (88,9 x 76,1mm)	85	2,100	300	*****
AR11542	4" x 2" (114,3 x 60,3mm)	102	2,500	300	*****
AR115473	4" x 2½" (114,3 x 73mm)	102	2,650	300	*****
AR1154212	4" x 2½" (114,3 x 76,1mm)	102	2,950	300	*****
AR11543	4" x 3" (114,3 x 88,9mm)	102	2,680	300	*****
AR1151412	5" x 2" (141 x 60,3mm)	121	4,560	300	*****
AR11514173	5" x 2½" (141 x 73mm)	121	4,560	300	*****
AR1151413	5" x 3" (141 x 88,9mm)	121	4,560	300	*****
AR1151414	5" x 4" (141 x 114,3mm)	121	4,500	300	*****
AR1151652	6" x 2" (165,1 x 60,3mm)	140	5,820	300	*****
AR11516573	6" x 2½" (165,1 x 73,0mm)	140	5,760	300	*****
AR115165212	6" x 2½" (165,1 x 76,1mm)	140	6,700	300	*****
AR1151653	6" x 3" (165,1 x 88,9mm)	140	6,200	300	*****
AR1151654	6" x 4" (165,1 x 114,3mm)	140	6,200	300	*****
AR115168141	6" x 5" (165,1 x 141mm)	140	7,000	300	*****
AR1151682	6" x 2" (168,3 x 60,3mm)	140	5,820	300	*****
AR11516873	6" x 2½" (168,3 x 73,0mm)	140	5,760	300	*****
AR115168212	6" x 2½" (168,3 x 76,1mm)	140	7,460	300	*****
AR1151683	6" x 3" (168,3 x 88,9mm)	140	6,200	300	*****
AR1151684	6" x 4" (168,3 x 114,3mm)	140	6,200	300	*****
AR115873	8" x 2½" (219,1 x 73mm)	175	11,050	300	*****
AR1158212	8" x 2½" (219,1 x 76mm)	175	11,050	300	*****
AR11583	8" x 3" (219,1 x 88,9mm)	175	11,050	300	*****



## Conexões ranhuradas

AR11584	8" x 4" (219,1 x 114,3mm)	175	12,420	300	*****
AR11585	8" x 5" (219,1 x 139,7mm)	175	12,500	300	*****
AR1158141	8" x 5" (219,1 x 141mm)	175	12,500	300	*****
AR1158165	8" x 6" (219,1 x 165,1mm)	175	13,000	300	*****
AR1158168	8" x 6" (219,1 x 168,3mm)	175	12,350	300	*****
AR115103	10" x 3" (273 x 88,9mm)	215	22,000	300	*****
AR115104	10" x 4" (273 x 114,3mm)	215	16,550	300	*****
AR11510141	10" x 5" (273 x 141mm)	215	23,500	300	*****
AR11510165	10" x 6" (273 x 165mm)	215	17,500	300	*****
AR11510168	10" x 6" (273 x 168mm)	215	17,500	300	*****
AR115108	10" x 8" (273 x 219,1mm)	215	19,000	300	*****
AR11512168	12" x 6" (323,9 x 168mm)	220	24,520	300	*****
AR115128	12" x 8" (323,9 x 219,1mm)	220	29,000	300	*****
AR1151210	12" x 10" (323,9 x 273mm)	220	29,000	300	*****

## TAMPÃO RANHURADO UL/FM



CÓDIGO	BITOLA	L	Peso	Pressão	Preço
AR155T1	1" (33,7mm)	23	0,070	300	*****
AR155T114	1¼" (42,4mm)	23	0,080	300	*****
AR155T112	1½" (48,3mm)	23	0,110	300	*****
AR155T2	2" (60,3mm)	23	0,200	300	*****
AR155T73	2½" (73mm)	23	0,300	300	*****
AR155T212	2½" (76,1mm)	23	0,300	300	*****
AR155T3	3" (88,9mm)	23	0,400	300	*****
AR155T4	4" (114,3mm)	25	0,600	300	*****
AR155T5	5" (139,7mm)	25	0,930	300	*****
AR155T141	5" (141mm)	25	0,930	300	*****
AR155T165	6" (165,1mm)	25	1,600	300	*****
AR155T168	6" (168,3mm)	25	1,600	300	*****
AR155T8	8" (219,1mm)	30	3,400	300	*****
AR155T10	10" (273mm)	32	5,360	300	*****
AR155T12	12" (323,9mm)	32	6,000	300	*****



# Conexões ranhuradas

## SAÍDA SPRINKLER BSP UL/FM continuar pos 48

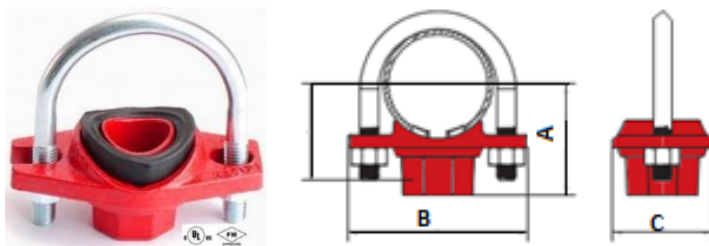

CÓDIGO	BITOLA	A	B	C	Peso	Pressão	Preço
AR13112	1" x ½" (33,7 x Rc½")	45	89	58	0,330	300	*****
AR13134	1" x ¾" (33,7 x Rc¾")	45	89	58	0,330	300	*****
AR1311412	1¼" x ½" (42,4 x Rc½")	49	89	58	0,410	300	*****
AR1311434	1¼" x ¾" (42,4 x Rc¾")	49	89	58	0,430	300	*****
AR131141	1¼" x 1" (42,4 x Rc1")	49	89	58	0,430	300	*****
AR1311212	1½" x ½" (48,3 x Rc½")	52	89	58	0,410	300	*****
AR1311234	1½" x ¾" (48,3 x Rc¾")	52	89	58	0,420	300	*****
AR131121	1½" x 1" (48,3 x Rc1")	52	89	58	0,450	300	*****
AR13212	2" x ½" (60,3 x Rc½")	58	89	58	0,290	300	*****
AR13234	2" x ¾" (60,3 x Rc¾")	58	89	58	0,380	300	*****
AR1321412	2¼" x ½" (60,3 x Rc½")	58	89	58	0,420	300	*****
AR1321434	2¼" x ¾" (60,3 x Rc¾")	58	89	58	0,420	300	*****
AR132141	2¼" x 1" (60,3 x Rc1")	58	89	58	0,650	300	*****
AR1321212	2½" x ½" (73,0 x Rc½")	68	89	58	0,440	300	*****
AR1321234	2½" x ¾" (73,0 x Rc¾")	68	89	58	0,490	300	*****
AR132121	2½" x 1" (76,1 x Rc1")	68	89	58	0,400	300	*****
AR13234	2" x ¾" (76,1 x Rc¾")	68	89	58	0,410	300	*****
AR1321412	2¼" x ½" (76,1 x Rc½")	68	89	58	0,450	300	*****
AR1331	3" x 1" (88,9 x Rc1")	80	89	58	0,550	300	*****



# Conexões ranhuradas

## TEE MECÂNICO RANHURADO UL/FM

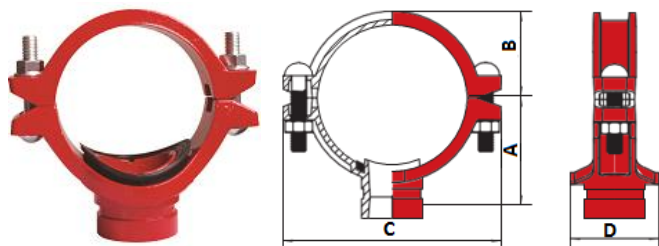

CÓDIGO	BITOLA	A	B	C	D	Peso	Pressão	Preço
AR152114	2" x 1¼" (60,3 x 42,4mm)	72	42	120	84	0,840	300	*****
AR152112	2" x 1½" (60,3 x 48,3mm)	72	42	120	84	0,930	300	*****
AR1573114	2½" x 1¼" (73 x 42,4mm)	78	47	143	84	0,990	300	*****
AR1573112	2½" x 1½" (73 x 48,3mm)	78	47	143	90	1,050	300	*****
AR152121	2½" x 1" (76,1 x 33,7mm)	79	48	143	76	0,870	300	*****
AR15212114	2½" x 1¼" (76,1 x 42,4mm)	80	48	143	84	0,990	300	*****
AR15212112	2½" x 1½" (76,1 x 48,3mm)	80	48	143	90	1,050	300	*****
AR153114	3" x 1¼" (88,9 x 42,4mm)	86	55	158	84	1,140	300	*****
AR153112	3" x 1½" (88,9 x 48,3mm)	86	55	158	90	1,170	300	*****
AR1532	3" x 2" (88,9 x 60,3mm)	87	55	158	101	1,300	300	*****
AR154114	4" x 1¼" (114,3 x 42,4mm)	99	65	181	84	1,540	300	*****
AR154112	4" x 1½" (114,3 x 48,3mm)	99	65	181	90	1,600	300	*****
AR1542	4" x 2" (114,3 x 60,3mm)	99	65	181	101	1,630	300	*****
AR15473	4" x 2½" (114,3 x 73mm)	99	65	181	117	1,850	300	*****
AR154212	4" x 2½" (114,3 x 76,1mm)	99	65	181	117	1,850	300	*****
AR1543	4" x 3" (114,3 x 88,9mm)	99	65	181	136	2,230	300	*****
AR1552	5" x 2" (139,7 x 60,3mm)	113	77	219	101	2,210	300	*****
AR15573	5" x 2½" (139,7 x 73mm)	113	77	219	117	2,290	300	*****
AR155212	5" x 2½" (139,7 x 76,1mm)	113	77	219	117	2,290	300	*****
AR1553	5" x 3" (139,7 x 88,9mm)	113	77	219	136	2,460	300	*****
AR151412	5" x 2" (141 x 60,3mm)	113	77	219	101	2,210	300	*****
AR1514173	5" x 2½" (141 x 73mm)	113	77	219	117	2,290	300	*****
AR15141212	5" x 2½" (141 x 76,1mm)	113	77	219	117	2,290	300	*****
AR151413	5" x 3" (141 x 88,9mm)	113	77	219	136	2,460	300	*****
AR15165114	6" x 11/4" (165,1 x 42,8mm)	125	94	248	84	2,410	300	*****
AR15165112	6" x 11/2" (165,1 x 48,3mm)	125	94	248	90	2,410	300	*****
AR151652	6" x 2" (165,1 x 60,3mm)	125	94	248	101	2,720	300	*****
AR1516573	6" x 2½" (165,1 x 73mm)	125	94	248	117	0,000	300	*****
AR15165212	6" x 2½" (165,1 x 76,1mm)	125	94	248	117	2,960	300	*****
AR151653	6" x 3" (165,1 x 88,9mm)	125	94	248	136	2,890	300	*****
AR151654	6" x 4" (165,1 x 114,3mm)	129	94	248	162	3,280	300	*****
AR15168114	6" x 11/4" (168,3 x 42,4mm)	125	97	248	84	2,410	300	*****
AR15168112	6" x 11/2" (168,3 x 48,3mm)	125	97	248	90	2,410	300	*****



## Conexões ranhuradas

AR151682	6" x 2" (168,3 x 60,3mm)	125	97	248	101	2,720	300	*****
AR1516873	6" x 2½" (168,3 x 73mm)	127	97	248	117	2,960	300	*****
AR15168212	6" x 2½" (168,3 x 76,1mm)	127	97	248	117	2,960	300	*****
AR151683	6" x 3" (168,3 x 88,9mm)	127	97	248	136	2,890	300	*****
AR151684	6" x 4" (168,3 x 114,3mm)	129	97	248	162	3,280	300	*****
AR1582	8" x 2" (219,1 x 60,3mm)	152	125	322	101	3,360	300	*****
AR15873	8" x 2½" (219,1 x 73mm)	154	125	322	117	3,320	300	*****
AR158212	8" x 2½" (219,1 x 76,1mm)	154	125	322	117	3,320	300	*****
AR1583	8" x 3" (219,1 x 88,9mm)	154	125	322	136	3,660	300	*****
AR1584	8" x 4" (219,1 x 114,3mm)	156	125	322	162	4,430	300	*****
AR15104	10" x 4" (273 x 114,3mm)						300	*****
AR1510165	10" x 6" (273 x 165,1mm)						300	*****

## TEE MECÂNICO ROSCADO BSP UL/FM

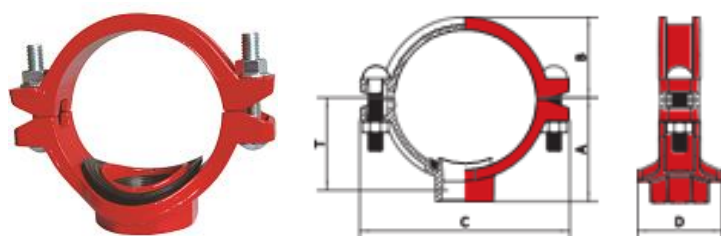

CÓDIGO	BITOLA	Diâmetro de Furo	A	B	C	D	Peso	Pressão	Preço
AR16212	2" x ½" (60,3 x Rc½")							300	*****
AR16234	2" x ¾" (60,3 x Rc¾")							300	*****
AR1621	2" x 1" (60,3 x Rc1")	38	56	42	120	76	0,640	300	*****
AR162114	2" x 1¼" (60,3 x Rc1¼")	51	68	42	120	84	0,740	300	*****
AR162112	2" x 1½" (60,3 x Rc1½")	51	71	42	120	84	0,870	300	*****
AR167312	2½" x ½" (73 x Rc½")							300	*****
AR167334	2½" x ¾" (73 x Rc¾")							300	*****
AR16731	2½" x 1" (73 x Rc1")	38	61	47	143	76	0,870	300	*****
AR1673114	2½" x 1¼" (73 x Rc1¼")	51	73	47	143	84	0,870	300	*****
AR1673112	2½" x 1½" (73 x Rc1½")	51	73	47	143	90	0,970	300	*****
AR1621212	2½" x ½" (76,1 x Rc½")							300	*****
AR1621234	2½" x ¾" (76,1 x Rc¾")							300	*****
AR162121	2½" x 1" (76,1 x Rc1")	38	61	48	143	76	0,870	300	*****
AR16212114	2½" x 1¼" (76,1 x Rc1¼")	51	73	48	143	84	0,870	300	*****
AR16212112	2½" x 1½" (76,1 x Rc1½")	51	75	48	143	90	0,970	300	*****
AR16312	3" x ½" (88,9 x Rc½")							300	*****
AR16334	3" x ¾" (88,9 x Rc¾")							300	*****
AR1631	3" x 1" (88,9 x Rc1")	38	69	55	158	76	0,930	300	*****
AR163114	3" x 1¼" (88,9 x Rc1¼")	51	81	55	158	84	1,060	300	*****
AR163112	3" x 1½" (88,9 x Rc1½")	51	81	55	158	90	1,130	300	*****



## Conexões ranhuradas

AR1632	3" x 2" (88,9 x Rc2")	64	81	55	158	101	1,230	300	*****
AR1641	4" x 1" (114,3 x Rc1")	38	82	65	181	76	1,230	300	*****
AR164114	4" x 1¼" (114,3 x Rc1¼")	51	94	65	181	84	1,270	300	*****
AR164112	4" x 1½" (114,3 x Rc1½")	51	94	65	181	90	1,300	300	*****
AR1642	4" x 2" (114,3 x Rc2")	64	94	65	181	101	1,370	300	*****
AR164212	4" x 2½" (114,3 x Rc2½")	70	99	65	181	117	1,530	300	*****
AR1643	4" x 3" (114,3 x Rc3")	89	100	65	181	136	1,780	300	*****
AR1651	5" x 1" (139,7 x Rc1")	38	100	77	219	76	1,700	300	*****
AR165114	5" x 1¼" (139,7 x Rc1¼")	51	107	77	219	84	1,750	300	*****
AR165112	5" x 1½" (139,7 x Rc1½")	51	107	77	219	90	1,770	300	*****
AR1652	5" x 2" (139,7 x Rc2")	64	108	77	219	101	1,900	300	*****
AR165212	5" x 2½" (139,7 x Rc2½")		115	77	219	117	2,030	300	*****
AR1653	5" x 3" (139,7 x Rc3")	89	118	77	219	136	2,270	300	*****
AR161411	5" x 1" (141 x Rc1")	38	96	77	219	76	1,700	300	*****
AR16141114	5" x 1¼" (141 x Rc1¼")	51	107	77	219	84	1,750	300	*****
AR16141112	5" x 1½" (141 x Rc1½")	51	107	77	219	90	1,770	300	*****
AR161412	5" x 2" (141 x Rc2")	64	108	77	219	101	1,900	300	*****
AR16141212	5" x 2½" (141 x Rc2½")							300	*****
AR161413	5" x 3" (141 x Rc3")	89	118	77	219	136	2,270	300	*****
AR161651	6" x 1" (165,1 x Rc1")	38	108	94	248	76	1,930	300	*****
AR16165114	6" x 1¼" (165,1 x Rc1¼")	51	120	94	248	84	2,210	300	*****
AR16165112	6" x 1½" (165,1 x Rc1½")	51	120	94	248	90	2,200	300	*****
AR161652	6" x 2" (165,1 x Rc2")	64	121	94	248	101	2,270	300	*****
AR16165212	6" x 2½" (165,1 x Rc2½")							300	*****
AR161653	6" x 3" (165,1 x Rc3")	89	129	94	248	136	2,470	300	*****
AR161654	6" x 4" (165,1 x Rc4")							300	*****
AR161681	6" x 1" (168,3 x Rc1")	38	108	97	248	76	1,930	300	*****
AR16168114	6" x 1¼" (168,3 x Rc1¼")	51	120	97	248	84	2,210	300	*****
AR16168112	6" x 1½" (168,3 x Rc1½")	51	120	97	248	90	2,200	300	*****
AR161682	6" x 2" (168,3 x Rc2")	64	121	97	248	101	2,270	300	*****
AR16168212	6" x 2½" (168,3 x Rc2½")	70	128	97	248	117	2,470	300	*****
AR161683	6" x 3" (168,3 x Rc3")	89	131	97	248	136	2,470	300	*****
AR161684	6" x 4" (168,3 x Rc4")							300	*****
AR1681	8" x 1" (219,1 x Rc1")	38	136	125	322	76	3,020	300	*****
AR168114	8" x 1¼" (219,1 x Rc1¼")	51	147	125	322	84	3,080	300	*****
AR168112	8" x 1½" (219,1 x Rc1½")	51	147	125	322	90	3,090	300	*****
AR1682	8" x 2" (219,1 x Rc2")	64	147	125	322	101	3,220	300	*****
AR168212	8" x 2½" (219,1 x Rc2½")							300	*****
AR1683	8" x 3" (219,1 x Rc3")	89	158	125	322	136	3,530	300	*****
AR1684	8" x 4" (219,1 x Rc4")	114	167	125	322	162	3,970	300	*****





# Conexões ranhuradas

## CRUZETA MECÂNICA RANHURADA

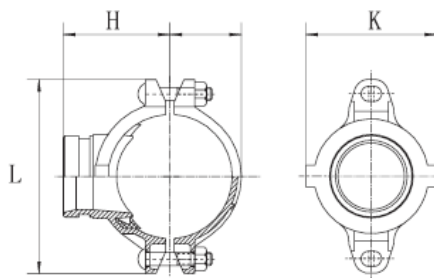

CÓDIGO	BITOLA	Diâmetro de Furo	L	K	H	Peso	Pressão	Preço
AR15D2114	2" x 1¼" (60,3 x 42,4mm)	51	116	68	75	1,120	300	*****
AR15D2112	2" x 1½" (60,3 x 48,3mm)	51	116	68	75	1,350	300	*****
AR15D73114	2½" x 1¼" (73 x 42,4mm)	51	128	76	83	1,000	300	*****
AR15D73112	2½" x 1½" (73 x 48,3mm)	51	128	76	83	1,270	300	*****
AR15D212114	2½" x 1¼" (76,1 x 42,4mm)	51	128	76	83	1,000	300	*****
AR15D212112	2½" x 1½" (76,1 x 48,3mm)	51	128	76	83	1,270	300	*****
AR15D3114	3" x 1¼" (88,9 x 42,4mm)	51	151	83	86	1,350	300	*****
AR15D3112	3" x 1½" (88,9 x 48,3mm)	51	151	83	86	1,470	300	*****
AR15D32	3" x 2" (88,9 x 60,3mm)	64	151	83	101	1,620	300	*****
AR15D4114	4" x 1¼" (114,3 x 42,4mm)	51	183	100	86	1,780	300	*****
AR15D4112	4" x 1½" (114,3 x 48,3mm)	51	183	100	86	1,820	300	*****
AR15D42	4" x 2" (114,3 x 60,3mm)	64	183	100	105	1,630	300	*****
AR15D473	4" x 2½" (114,3 x 73mm)	70	183	100	110	2,100	300	*****
AR15D4212	4" x 2½" (114,3 x 76,1mm)	70	183	100	110	2,100	300	*****
AR15D43	4" x 3" (114,3 x 88,9mm)	89	183	100	124	3,230	300	*****
AR15D52	5" x 2" (139,7 x 60,3mm)	64	219	110	105	2,720	300	*****
AR15D5212	5" x 2½" (139,7 x 76,1mm)	70	219	110	110	3,000	300	*****
AR15D53	5" x 3" (139,7 x 88,9mm)	89	219	110	124	3,020	300	*****
AR15D1412	5" x 2" (141 x 60,3mm)	64	219	110	105	2,720	300	*****
AR15D141212	5" x 2½" (141 x 76,1mm)	70	219	110	110	3,000	300	*****
AR15D165114	6" x 11/4" (165,1 x 42,8mm)	51	245	123	90	2,450	300	*****
AR15D165112	6" x 11/2" (165,1 x 48,3mm)	51	245	123	90	2,350	300	*****
AR15D1652	6" x 2" (165,1 x 60,3mm)	64	245	123	105	2,580	300	*****
AR15D165212	6" x 2½" (165,1 x 76,1mm)	70	245	123	110	2,900	300	*****
AR15D1653	6" x 3" (165,1 x 88,9mm)	89	245	123	130	4,260	300	*****
AR15D1654	6" x 4" (165,1 x 114,3mm)	114	245	125	159	4,500	300	*****



## Conexões ranhuradas

AR15D168114	6" x 11/4" (168,3 x 42,4mm)	51	250	127	90	2,450	300	*****
AR15D168112	6" x 11/2" (168,3 x 48,3mm)	51	250	127	90	2,350	300	*****
AR15D1682	6" x 2" (168,3 x 60,3mm)	64	250	127	105	2,580	300	*****
AR15D16873	6" x 2½" (168,3 x 73mm)	70	250	127	110	2,900	300	*****
AR15D168212	6" x 2½" (168,3 x 76,1mm)	70	250	127	110	2,090	300	*****
AR15D1683	6" x 3" (168,3 x 88,9mm)	89	250	127	130	4,260	300	*****
AR15D1684	6" x 4" (168,3 x 114,3mm)	114	250	127	159	4,500	300	*****
AR15D82	8" x 2" (219,1 x 60,3mm)	64	302	150	105	3,820	300	*****
AR15D873	8" x 2½" (219,1 x 73mm)	70	302	150	115	4,020	300	*****
AR15D8212	8" x 2½" (219,1 x 76,1mm)	70	302	150	115	4,020	300	*****
AR15D83	8" x 3" (219,1 x 88,9mm)	89	302	150	134	5,650	300	*****
AR15D84	8" x 4" (219,1 x 114,3mm)	114	302	150	167	6,110	300	*****
AR15D104	10" x 4" (273 x 114,3mm)	114				10,700	300	*****
AR15D10165	10" x 6" (273 x 165,1mm)	114				12,000	300	*****

## CRUZETA MECÂNICA ROSCADA BSP UL/FM

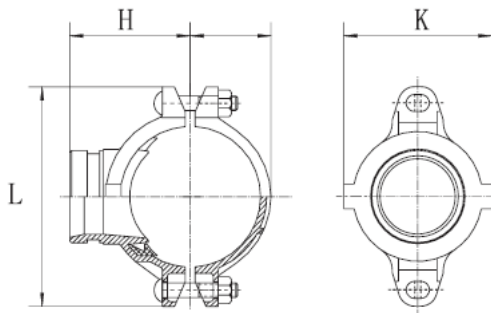

CÓDIGO	BITOLA	Diâmetro de Furo	L	K	H	Peso	Pressão	Preço
AR16D21	2" x 1" (60,3 x Rc1")	51	116	58	72	0,840	300	*****
AR16D2114	2" x 1¼" (60,3 x Rc1¼")	51	116	63	75	1,120	300	*****
AR16D2112	2" x 1½" (60,3 x Rc1½")	51	116	68	75	1,350	300	*****
AR16D731	2½" x 1" (73 x Rc1")	51	128	68	83	1,000	300	*****
AR16D73114	2½" x 1¼" (73 x Rc1¼")	51	128	76	72	1,000	300	*****
AR16D73112	2½" x 1½" (73 x Rc1½")	51	128	76	83	1,270	300	*****
AR16D2121	2½" x 1" (76,1 x Rc1")	51	128	68	83	1,000	300	*****
AR16D212114	2½" x 1¼" (76,1 x Rc1¼")	51	128	76	83	1,000	300	*****
AR16D212112	2½" x 1½" (76,1 x Rc1½")	51	128	76	83	1,270	300	*****
AR16D31	3" x 1" (88,9 x Rc1")	51	151	78	74	1,020	300	*****
AR16D3114	3" x 1¼" (88,9 x Rc1¼")	51	151	78	86	1,350	300	*****
AR16D3112	3" x 1½" (88,9 x Rc1½")	51	151	78	86	1,470	300	*****
AR16D32	3" x 2" (88,9 x Rc2")	64	151	78	101	1,620	300	*****



## Conexões ranhuradas

AR16D41	4" x 1" (114,3 x Rc1")	70	183	88	76	1,580	300	*****
AR16D4114	4" x 1¼" (114,3 x Rc1¼")	51	183	94	89	1,780	300	*****
AR16D4112	4" x 1½" (114,3 x Rc1½")	51	183	94	89	1,820	300	*****
AR16D42	4" x 2" (114,3 x Rc2")	64	183	98	105	1,630	300	*****
AR16D4212	4" x 2½" (114,3 x Rc2½")	70	183	100	110	2,100	300	*****
AR16D43	4" x 3" (114,3 x Rc3")	70	183	100	110	3,230	300	*****
AR16D51	5" x 1" (139,7 x Rc1")	89	219	103	80	1,790	300	*****
AR16D5114	5" x 1¼" (139,7 x Rc1¼")	51	219	103	93	1,890	300	*****
AR16D5112	5" x 1½" (139,7 x Rc1½")	51	219	103	93	1,940	300	*****
AR16D52	5" x 2" (139,7 x Rc2")	64	219	107	105	2,480	300	*****
AR16D5212	5" x 2½" (139,7 x Rc2½")	64	219	107	112	2,510	300	*****
AR16D53	5" x 3" (139,7 x Rc3")	70	219	110	131	2,930	300	*****
AR16D1411	5" x 1" (141 x Rc1")	51	219	103	80	1,790	300	*****
AR16D141114	5" x 1¼" (141 x Rc1¼")	51	219	103	93	1,890	300	*****
AR16D141112	5" x 1½" (141 x Rc1½")	51	219	103	93	1,940	300	*****
AR16D1412	5" x 2" (141 x Rc2")	64	219	107	105	2,480	300	*****
AR16D141212	5" x 2½" (141 x Rc2½")	64	219	107	112	2,510	300	*****
AR16D1413	5" x 3" (141 x Rc3")	70	219	110	131	2,930	300	*****
AR16D1651	6" x 1" (165,1 x Rc1")	51	245	116	80	2,170	300	*****
AR16D165114	6" x 1¼" (165,1 x Rc1¼")	51	245	120	90	2,330	300	*****
AR16D165112	6" x 1½" (165,1 x Rc1½")	51	245	120	90	2,460	300	*****
AR16D1652	6" x 2" (165,1 x Rc2")	64	245	123	105	2,620	300	*****
AR16D165212	6" x 2½" (165,1 x Rc2½")	70	245	123	110	2,900	300	*****
AR16D1653	6" x 3" (165,1 x Rc3")	89	245	123	130	3,330	300	*****
AR16D1681	6" x 1" (168,3 x Rc1")	51	250	117	80	2,170	300	*****
AR16D168114	6" x 1¼" (168,3 x Rc1¼")	51	250	121	90	2,330	300	*****
AR16D168112	6" x 1½" (168,3 x Rc1½")	51	250	121	90	2,460	300	*****
AR16D1682	6" x 2" (168,3 x Rc2")	64	250	124	105	2,620	300	*****
AR16D168212	6" x 2½" (168,3 x Rc2½")	70	250	124	110	2,900	300	*****
AR16D1683	6" x 3" (168,3 x Rc3")	89	250	124	130	3,330	300	*****
AR16D81	8" x 1" (219,1 x Rc1")	51	302	140	80	3,700	300	*****
AR16D8114	8" x 1¼" (219,1 x Rc1¼")	51	302	142	92	3,780	300	*****
AR16D8112	8" x 1½" (219,1 x Rc1½")	51	302	142	92	3,870	300	*****
AR16D82	8" x 2" (219,1 x Rc2")	64	302	150	105	3,820	300	*****



# Conexões ranhuradas

## TEE MECÂNICO RANHURADO UL/FM

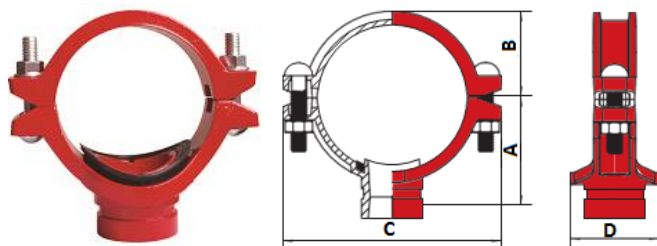

CÓDIGO	BITOLA	A	B	C	D	Peso	Pressão	Preço
AR152114	2" x 1¼" (60,3 x 42,4mm)	72	42	120	84	0,840	300	*****
AR152112	2" x 1½" (60,3 x 48,3mm)	72	42	120	84	0,930	300	*****
AR1573114	2½" x 1¼" (73 x 42,4mm)	78	47	143	84	0,990	300	*****
AR1573112	2½" x 1½" (73 x 48,3mm)	78	47	143	90	1,050	300	*****
AR152121	2½" x 1" (76,1 x 33,7mm)	79	48	143	76	0,870	300	*****
AR15212114	2½" x 1¼" (76,1 x 42,4mm)	80	48	143	84	0,990	300	*****
AR15212112	2½" x 1½" (76,1 x 48,3mm)	80	48	143	90	1,050	300	*****
AR153114	3" x 1¼" (88,9 x 42,4mm)	86	55	158	84	1,140	300	*****
AR153112	3" x 1½" (88,9 x 48,3mm)	86	55	158	90	1,170	300	*****
AR1532	3" x 2" (88,9 x 60,3mm)	87	55	158	101	1,300	300	*****
AR154114	4" x 1¼" (114,3 x 42,4mm)	99	65	181	84	1,540	300	*****
AR154112	4" x 1½" (114,3 x 48,3mm)	99	65	181	90	1,600	300	*****
AR1542	4" x 2" (114,3 x 60,3mm)	99	65	181	101	1,630	300	*****
AR15473	4" x 2½" (114,3 x 73mm)	99	65	181	117	1,850	300	*****
AR154212	4" x 2½" (114,3 x 76,1mm)	99	65	181	117	1,850	300	*****
AR1543	4" x 3" (114,3 x 88,9mm)	99	65	181	136	2,230	300	*****
AR1552	5" x 2" (139,7 x 60,3mm)	113	77	219	101	2,210	300	*****
AR15573	5" x 2½" (139,7 x 73mm)	113	77	219	117	2,290	300	*****
AR155212	5" x 2½" (139,7 x 76,1mm)	113	77	219	117	2,290	300	*****
AR1553	5" x 3" (139,7 x 88,9mm)	113	77	219	136	2,460	300	*****
AR151412	5" x 2" (141 x 60,3mm)	113	77	219	101	2,210	300	*****
AR1514173	5" x 2½" (141 x 73mm)	113	77	219	117	2,290	300	*****
AR15141212	5" x 2½" (141 x 76,1mm)	113	77	219	117	2,290	300	*****
AR151413	5" x 3" (141 x 88,9mm)	113	77	219	136	2,460	300	*****
AR15165114	6" x 11/4" (165,1 x 42,8mm)	125	94	248	84	2,410	300	*****
AR15165112	6" x 11/2" (165,1 x 48,3mm)	125	94	248	90	2,410	300	*****
AR151652	6" x 2" (165,1 x 60,3mm)	125	94	248	101	2,720	300	*****
AR1516573	6" x 2½" (165,1 x 73mm)	125	94	248	117	0,000	300	*****
AR15165212	6" x 2½" (165,1 x 76,1mm)	125	94	248	117	2,960	300	*****
AR151653	6" x 3" (165,1 x 88,9mm)	125	94	248	136	2,890	300	*****
AR151654	6" x 4" (165,1 x 114,3mm)	129	94	248	162	3,280	300	*****
AR15168114	6" x 11/4" (168,3 x 42,4mm)	125	97	248	84	2,410	300	*****
AR15168112	6" x 11/2" (168,3 x 48,3mm)	125	97	248	90	2,410	300	*****



## Conexões ranhuradas

AR151682	6" x 2" (168,3 x 60,3mm)	125	97	248	101	2,720	300	*****
AR1516873	6" x 2½" (168,3 x 73mm)	127	97	248	117	2,960	300	*****
AR15168212	6" x 2½" (168,3 x 76,1mm)	127	97	248	117	2,960	300	*****
AR151683	6" x 3" (168,3 x 88,9mm)	127	97	248	136	2,890	300	*****
AR151684	6" x 4" (168,3 x 114,3mm)	129	97	248	162	3,280	300	*****
AR1582	8" x 2" (219,1 x 60,3mm)	152	125	322	101	3,360	300	*****
AR15873	8" x 2½" (219,1 x 73mm)	154	125	322	117	3,320	300	*****
AR158212	8" x 2½" (219,1 x 76,1mm)	154	125	322	117	3,320	300	*****
AR1583	8" x 3" (219,1 x 88,9mm)	154	125	322	136	3,660	300	*****
AR1584	8" x 4" (219,1 x 114,3mm)	156	125	322	162	4,430	300	*****
AR15104	10" x 4" (273 x 114,3mm)						300	*****
AR1510165	10" x 6" (273 x 165,1mm)						300	*****

## REDUÇÃO CONCÊNTRICA RANHURADA UL/FM



CÓDIGO	BITOLA	A	Peso	Pressão	Preço
AR140112114	1½" x 1¼" (48,3 x 42,4mm)	64	0,360	300	*****
AR1402114	2" x 1¼" (60,3 x 42,4mm)	64	0,380	300	*****
AR1402112	2" x 1½" (60,3 x 48,3mm)	64	0,410	300	*****
AR14073114	2½" x 1¼" (73 x 42,4mm)	64	0,500	300	*****
AR14073112	2½" x 1½" (73 x 48,3mm)	64	0,500	300	*****
AR140732	2½" x 2" (73 x 60,3mm)	64	0,500	300	*****
AR140212112	2½" x 1½" (76,1 x 48,3mm)	64	0,500	300	*****
AR1402122	2½" x 2" (76,1 x 60,3mm)	64	0,500	300	*****
AR1403114	3" x 1¼" (88,9 x 42,4mm)	64	0,550	300	*****
AR1403112	3" x 1½" (88,9 x 48,3mm)	64	0,550	300	*****
AR14032	3" x 2" (88,9 x 60,3mm)	64	0,600	300	*****
AR140373	3" x 2½" (88,9 x 73mm)	64	0,600	300	*****
AR1403212	3" x 2½" (88,9 x 76,1mm)	64	0,600	300	*****
AR1404114	4" x 1¼" (114,3 x 42,4mm)			300	*****
AR1404112	4" x 1½" (114,3 x 48,3mm)			300	*****
AR14042	4" x 2" (114,3 x 60,3mm)	76	0,880	300	*****
AR140473	4" x 2½" (114,3 x 73mm)	76	0,900	300	*****
AR1404212	4" x 2½" (114,3 x 76,1mm)	76	0,950	300	*****
AR14043	4" x 3" (114,3 x 88,9mm)	76	0,950	300	*****



## Conexões ranhuradas

AR14052	5" x 2" (139,7 x 60,3mm)	76	1,060	300	*****
AR1405212	5" x 2½" (139,7 x 76,1mm)	85	1,600	300	*****
AR14053	5" x 3" (139,7 x 88,9mm)	85	1,600	300	*****
AR14054	5" x 4" (139,7 x 114,3mm)	85	1,630	300	*****
AR1401412	5" x 2" (141 x 60,3mm)	85	1,800	300	*****
AR140141212	5" x 2½" (141 x 76,1mm)	85	1,600	300	*****
AR1401413	5" x 3" (141 x 88,9mm)	85	1,600	300	*****
AR1401414	5" x 4" (141 x 114,3mm)	85	1,630	300	*****
AR1401652	6" x 2" (165,1 x 60,3mm)	85	1,800	300	*****
AR140165212	6" x 2½" (165,1 x 76,1mm)	102	2,500	300	*****
AR1401653	6" x 3" (165,1 x 88,9mm)	102	2,150	300	*****
AR1401654	6" x 4" (165,1 x 114,3mm)	102	2,100	300	*****
AR1401655	6" x 5" (165,1 x 139,7mm)	102	2,200	300	*****
AR1401682	6" x 2" (168,3 x 60,3mm)	102	2,400	300	*****
AR14016873	6" x 2½" (168,3 x 73,0mm)	102	2,500	300	*****
AR140168212	6" x 2½" (168,3 x 76,1mm)	102	2,150	300	*****
AR1401683	6" x 3" (168,3 x 88,9mm)	102	2,150	300	*****
AR1401684	6" x 4" (168,3 x 114,3mm)	102	2,100	300	*****
AR1401685	6" x 5" (168,3 x 139,7mm)	102	2,200	300	*****
AR140168141	6" x 5" (168,3 x 141mm)	102	2,400	300	*****
AR140873	8" x 2½" (219,1 x 73,0mm)	102	2,400	300	*****
AR1408212	8" x 2½" (219,1 x 76,1mm)	127	3,300	300	*****
AR14083	8" x 3" (219,1 x 88,9mm)	127	3,300	300	*****
AR14084	8" x 4" (219,1 x 114,3mm)	127	3,380	300	*****
AR14085	8" x 5" (219,1 x 139,7mm)	127	3,550	300	*****
AR1408141	8" x 5" (219,1 x 141mm)	127	3,400	300	*****
AR1408165	8" x 6" (219,1 x 165,1mm)	127	3,400	300	*****
AR1408168	8" x 6" (219,1 x 168,3mm)	127	3,500	300	*****
AR140104	10" x 4" (273 x 114,3mm)	127	3,500	300	*****
AR140105	10" x 5" (273 x 139,7mm)	127	6,300	300	*****
AR14010141	10" x 5" (273 x 141mm)	127	6,400	300	*****
AR14010165	10" x 6" (273 x 165,1mm)	127	6,400	300	*****
AR14010168	10" x 6" (273 x 168,3mm)	127	6,500	300	*****
AR140108	10" x 8" (273 x 219,1mm)	127	6,500	300	*****
AR140124	12" x 4" (323,9 x 114,3mm)	127	7,000	300	*****
AR140125	12" x 5" (323,9 x 139,7mm)	127	9,000	300	*****
AR14012141	12" x 5" (323,9 x 141mm)	127	9,000	300	*****
AR14012165	12" x 6" (323,9 x 165,1mm)	127	9,000	300	*****
AR14012168	12" x 6" (323,9 x 168,3mm)	127	9,000	300	*****
AR140128	12" x 8" (323,9 x 219,1mm)	127	9,000	300	*****
AR1401210	12" x 10" (323,9 x 273mm)	127	10,000	300	*****



# Conexões ranhuradas

## REDUÇÃO CONCÊNTRICA RANHURA X ROSCA UL/FM

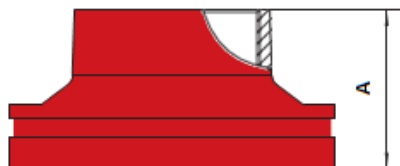

CÓDIGO	BITOLA	A	Peso	Pressão	Preço
AR140R1141	1.1/4" x 1" (42,4 x 33,7 mm)			300	*****
AR140R1121	1.1/2" x 1" (48,3 x 33,7 mm)			300	*****
AR140R112114	1.1/2" x 1.1/4" (48,3 x 42,4 mm)			300	*****
AR140R21	2" x 1" (60,3 x 33,7 mm)	64	0,400	300	*****
AR140R2114	2" x 1.1/4" (60,3 x 42,4 mm)	64	0,400	300	*****
AR140R2112	2" x 1.1/2" (60,3 x 48,3 mm)	64	0,400	300	*****
AR140R731	2.1/2" x 1" (73 x 33,7 mm)	64	0,500	300	*****
AR140R73114	2.1/2" x 1.1/4" (73 x 42,4 mm)	64	0,550	300	*****
AR140R73112	2.1/2" x 1.1/2" (73 x 48,3 mm)	64	0,580	300	*****
AR140R732	2.1/2" x 2" (73 x 60,3 mm)	64	0,650	300	*****
AR140R2121	2.1/2" x 1" (76,1 x 33,7 mm)	64	0,500	300	*****
AR140R212114	2.1/2" x 1.1/4" (76,1 x 42,4 mm)	64	0,550	300	*****
AR140R212112	2.1/2" x 1.1/2" (76,1 x 48,3 mm)	64	0,580	300	*****
AR140R2122	2.1/2" x 2" (76,1 x 60,3 mm)	64	0,650	300	*****
AR140R31	3" x 1" (88,9 x 33,7 mm)	64	0,650	300	*****
AR140R3114	3" x 1.1/4" (88,9 x 42,4 mm)	64	0,600	300	*****
AR140R3112	3" x 1.1/2" (88,9 x 48,3 mm)	64	0,630	300	*****
AR140R32	3" x 2" (88,9 x 60,3 mm)	64	0,740	300	*****
AR140R3212	3" x 2.1/2" (88,9 x 76,1 mm)	64	0,760	300	*****
AR140R41	4" x 1" (114,3 x 33,7 mm)	76	0,900	300	*****
AR14R4114	4" x 1.1/4" (114,3 x 42,4 mm)	76	0,900	300	*****
AR1404112 <sub>s</sub>	4" x 1.1/2" (114,3 x 48,3 mm)	76	0,900	300	*****
AR140R42	4" x 2" (114,3 x 60,3 mm)	76	1,000	300	*****
AR140R4212	4" x 2.1/2" (114,3 x 76,1 mm)	76	1,000	300	*****
AR140R43	4" x 3" (114,3 x 88,9 mm)	76	1,050	300	*****
AR140R1651	6" x 1" (165,1 x 33,7 mm)	85	2,100	300	*****
AR140R165114	6" x 1.1/4" (165,1 x 42,4 mm)	85	2,100	300	*****
AR140R165112	6" x 1.1/2" (165,1 x 48,5 mm)	85	2,150	300	*****
AR140R1652	6" x 2" (165,1 x 60,3 mm)	85	2,200	300	*****
AR140R165212	6" x 2.1/2" (165,1 x 76,1 mm)	85	2,250	300	*****
AR140R1653	6" x 3" (165,1 x 88,9 mm)	85	2,250	300	*****
AR140R1651	6" x 1" (165,1 x 33,7 mm)	85	2,100	300	*****
AR140R165114	6" x 1.1/4" (165,1 x 42,4 mm)	85	2,100	300	*****



## Conexões ranhuradas

AR140R165112	6" x 1 1/2" (165,1 x 48,5 mm)	85	2,150	300	*****
AR140R1652	6" x 2" (165,1 x 60,3 mm)	85	2,200	300	*****
AR140R165212	6" x 2 1/2" (165,1 x 76,1 mm)	85	2,250	300	*****
AR140R1653	6" x 3" (165,1 x 88,9 mm)	85	2,250	300	*****
AR140R1654	6" x 4" (165,1 x 114,3 mm)	85	2,350	300	*****
AR140R1681	6" x 1" (168,3 x 33,7 mm)	85	1,850	300	*****
AR140R168114	6" x 1 1/4" (168,3 x 42,4 mm)	85	1,900	300	*****
AR140R168112	6" x 1 1/2" (168,3 x 48,3 mm)	85	1,900	300	*****
AR140R1682	6" x 2" (168,3 x 60,3 mm)	85	2,050	300	*****
AR140R168212	6" x 2 1/2" (168,3 x 76,0 mm)	85	2,000	300	*****
AR140R1683	6" x 3" (168,3 x 88,9 mm)	85	2,100	300	*****
AR140R1684	6" x 4" (168,3 x 114,3 mm)	85	2,200	300	*****
AR140R81	8" x 1" (219,1 x 33,7 mm)	85	3,500	300	*****
AR140R8114	8" x 1 1/4" (219,1 x 42,4 mm)	85	3,400	300	*****
AR140R8112	8" x 1 1/2" (219,1 x 48,3 mm)	85	3,900	300	*****
AR140R82	8" x 2" (219,1 x 60,3 mm)	85	3,900	300	*****
AR140R8212	8" x 2 1/2" (219,1 x 76,1 mm)	85	4,150	300	*****
AR140R83	8" x 3" (219,1 x 88,9 mm)	85	4,150	300	*****
AR140R84	8" x 4" (219,1 x 114,3 mm)	85	4,500	300	*****

## REDUÇÃO EXCÊNTRICA RANHURADA UL/FM

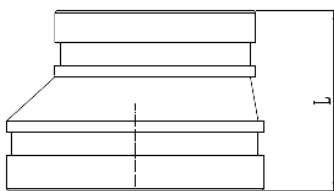

CÓDIGO	BITOLA	A	Peso	Pressão	Preço
AR14343	4" x 3" (114,3 x 88,9mm)	102	0.99	300	*****
AR1431654	6" x 4" (165,1 x 114,3mm)	102	2.30	300	*****
AR1438165	8" x 6" (219,1 x 165,1mm)	127	4.10	300	*****

